

BEFORE THE BOARD OF COUNTY COMMISSIONERS
FOR COLUMBIA COUNTY, OREGON

In the Matter of Acquiring a Perpetual Right of Way Easement)
and a Temporary Construction Easement from John F. and) Resolution No. 32-2008
Betty Jean Cook for the Replacement of the Bridge on Lost)
Creek Road)

WHEREAS, Columbia County is in the process of replacing the bridge on Lost Creek Road; and

WHEREAS, certain property must be acquired for a Perpetual Right-of-Way Easement, to successfully complete the bridge replacement under the authority of ORS 35.605; and

WHEREAS, certain property must be acquired for a Temporary Construction Easement; and

WHEREAS, the property which must be acquired to successfully complete and maintain said improvements is described and depicted in Attachments 1-3; and

WHEREAS, pursuant to ORS 35.610, before the right to acquire such property under ORS 35.605 is exercised, the Board of County Commissioners shall describe the land to be purchased, acquired, entered upon or appropriated, and shall determine that the appropriation of such land is reasonably necessary to protect the full use and enjoyment by the public of the road, street or highway;

NOW, THEREFORE, IT IS HEREBY RESOLVED as follows:

1. A Perpetual Right-of-Way Easement, as described and depicted in Attachment 1 and Attachment 2, which are attached hereto and incorporated herein by this reference, shall be purchased, acquired, entered upon or appropriated for said project; and
2. A Temporary Construction Easement, as described and depicted in Attachment 3, which is attached hereto and incorporated herein by this reference, shall be purchased, acquired, entered upon or appropriated for said project.
3. The easements authorized by this Resolution shall be recorded with the County Clerk without costs.

// //

// //

// //

// //

// //

// //

4. The purchase, acquisition, or appropriation of such land is reasonably necessary to protect the full use and enjoyment by the public of the road, street or highway.

Dated this 23rd day of April, 2008.

Approved as to form

By:

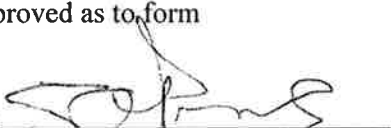

County Counsel

BOARD OF COUNTY COMMISSIONERS
FOR COLUMBIA COUNTY, OREGON

By:

Chair

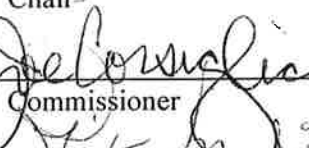
By:

Commissioner

By:

Commissioner



ATTACHMENT 1

14315 SW Cougar Ridge Dr.
Beaverton, Oregon 97008
Ph: 503-590-7158
Fax: 503-521-8372
Email: d.mills@verizon.net

DEDICATION

WEST SIDE of G.W. RICHARDSON ROAD

COOK TO COLUMBIA COUNTY

A roadway Dedication, being part of that Tract of land described in Deed to John F. & Betty Jean Cook & Russell E. & Rosemarie Cook recorded May 21, 1984 in Book 252, Page 68, Columbia County deed records being situated in the Northeast one quarter of Section 20, Township 7 North, Range 3 West, Willamette Meridian, Columbia County, Oregon, being more particularly described as follows:

Beginning at the Northeast Corner of Section 20; thence along the East line of said Section 20, S 0° 16' 04" W a distance of 1329.69 feet to a point on the East Right of Way line of G.W. Richardson Road (County Road No. 123) being 20.00 feet Westerly of centerline; thence along Right of Way, S 10° 46' 12" W a distance of 50.82 feet; thence leaving East Right of Way line, N 79° 13' 48" W a distance of 40.00 feet to a point on the West Right of Way line of said G.W. Richardson Road said point also being the **TRUE POINT OF BEGINNING** of the herein described Dedication; thence leaving said West Right of Way line, N 28° 06' 18" W a distance of 15.93 feet to a point being 30.00 feet when measured at right angles to the centerline of said G.W. Richardson Road; thence parallel to said centerline, N 10° 46' 12" E a distance of 89.14 feet; thence along a 670.00 foot radius curve concave to the West through a central angle of 10° 06' 37" (chord bears N 5° 42' 54" E, a distance of 118.07 feet) an arc distance of 118.23 feet; thence N 17° 28' 38" E a distance of 34.56 feet to a point on the said West Right of Way line; thence along said West Right of Way line, S 0° 39' 36" W a distance of 33.09 feet; thence along a 680.00 foot radius curve concave to the West through a central angle of 10° 06' 37" (chord bears S 5° 42' 54" W, a distance of 119.83 feet) an arc distance of 119.99 feet; thence S 10° 46' 12" W a distance of 101.55 feet to the true point of beginning.

The above described Dedication contains 2310 square feet, more or less.

THE BASIS OF BEARINGS IS OREGON STATE COORDINATE SYSTEM, NORTH ZONE, NAD 83 (CORS96).



ATTACHMENT 3

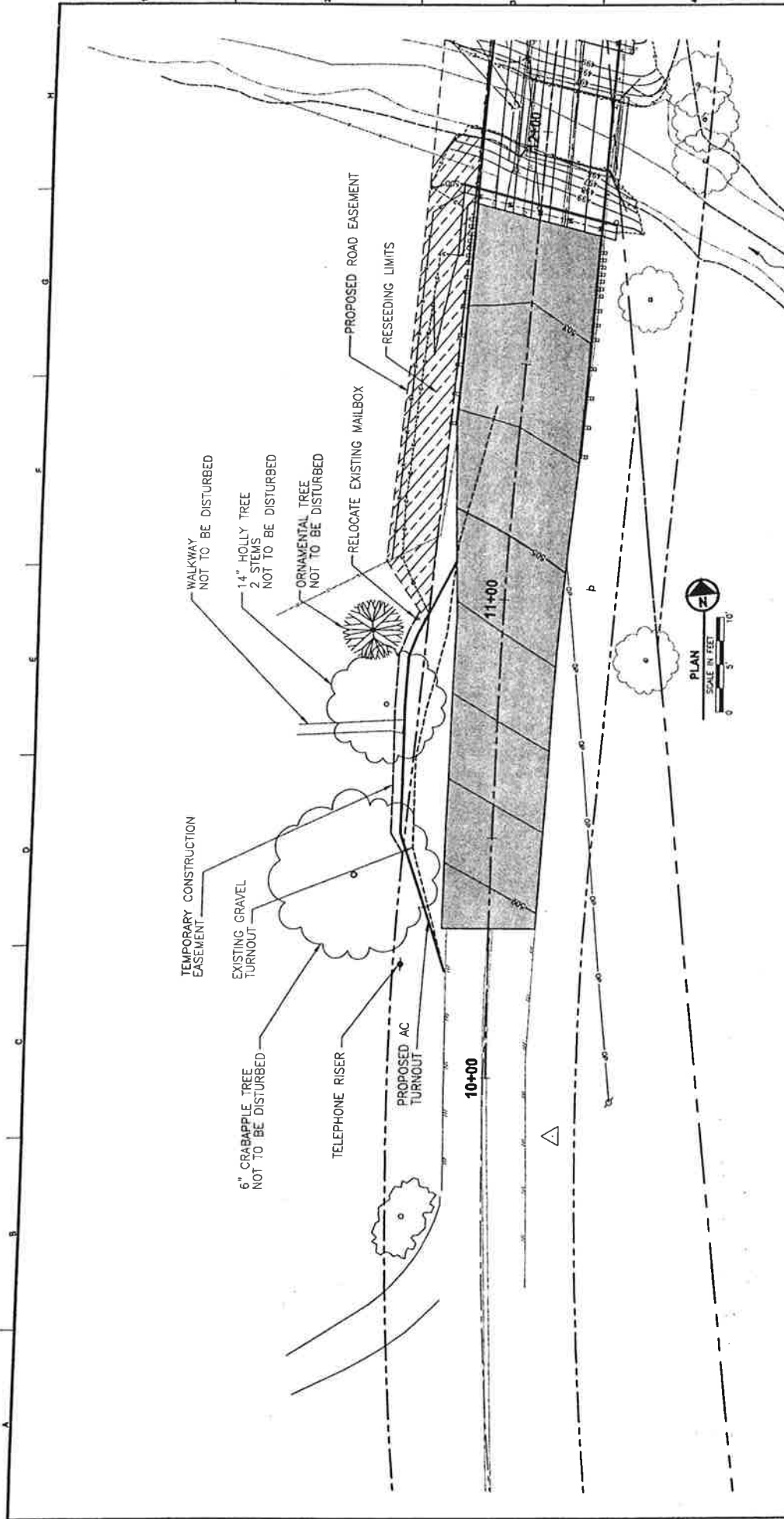

DATE: 08/21/2007 10:58 AM PLOTTER: HP DesignJet 5000

<table border="1"> <tr> <td>NO. 1</td> <td>DATE</td> <td>BY</td> <td>CHKD.</td> <td>APP'D.</td> </tr> <tr> <td> </td> <td> </td> <td> </td> <td> </td> <td> </td> </tr> </table>	NO. 1	DATE	BY	CHKD.	APP'D.						<p>PROJECT NAME OTIA III BRIDGE REPLACEMENTS BRIDGE # 42, 56 AND 18 COLUMBIA COUNTY ROAD DEPARTMENT COLUMBIA COUNTY, OREGON</p>	<p>DRAWING NO. 1 OF 1</p>
NO. 1	DATE	BY	CHKD.	APP'D.								
<p>Parametrix INC. 1000 N. W. 10TH AVE. SUITE 100 GAINESVILLE, FL 32609 TEL: 352-344-1000 FAX: 352-344-1001 WWW.PARAMETRIX.COM</p>												